

Product Enhancement

Machines/Models: All SL-20D Series
Work Platforms

Serial Nos.: 4300-4582

SERVICE BULLETIN: 93.2

DATE: July 1, 1993

PURPOSE: To notify of a change to improve steering while driving at high system pressure.

OPERATION REQUIRED:

1. Remove the gage quick disconnect fitting.
2. Install spacer, ball and spring.
3. Re-install gage quick disconnect fitting.

PARTS REQUIRED:

1- 30675-000-00 Check ball kit.

REIMBURSEMENT: Installation can be completed in 15 minutes. UpRight will reimburse you @ \$25.00 US per hour. Reimbursement for labor will be made after receipt of your completed warranty claim.

PROCEDURE:

1. Remove gage quick disconnect fitting, Item A.
2. Insert spacer, Item B, tapered end first, into quick disconnect port.
3. Tap spacer to bottom of port with drift punch.
4. Insert ball, Item C, into port and seat against spacer by striking the ball lightly with a drift and hammer.
5. Insert spring, Item D, into the port.
6. Install the gage quick disconnect fitting, compressing the spring, and tighten the fitting to 25 Ft/Lbs (26 Nm).
7. Operate the machine and check for proper function and leaks.

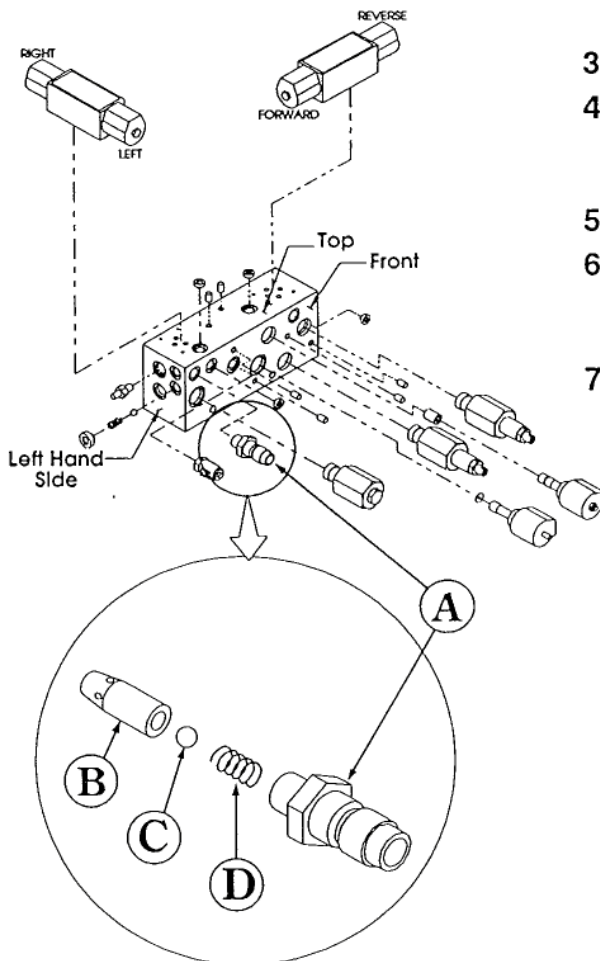

If you have any questions regarding this product enhancement, please contact the UpRight Service Department at (800) 926-5438, in the USA; (209) 896-5150, outside the USA; or by FAX at (209) 896-9244