



SERVICE BULLETIN SB03.01

Machines/Models: LX 31/41/50 4WD **Serial Numbers:** 1300-4472

DATE: November 01, 2003

MANDATORY COMPLETION OF THIS BULLETIN REQUIRED WITHIN 30 DAYS OF RECEIPT

PURPOSE: To assure proper fit of front wheel motor hubs and inspect for possible damage to motor shafts.

REIMBURSEMENT: UpRight will reimburse the owner of record for 1.0 hour of labor at 60.00 per hour. Reimbursement will be made upon receipt of your warranty claim form by UpRight, Inc. Please indicate SB03.01 on claim form.

Parts Supplied:

2. (2) Cotter Pin part# 011754-012
3. (2) Castle Nuts part# 067607-021
4. (2) Shear Key part# 067607-018

READ ALL INSTRUCTIONS AND REVIEW ALL FIGURES BEFORE PERFORMING THE FOLLOWING INSTRUCTIONS. **

WARNING: Be sure platform is fully lowered, and machine is on level surface and supported on jack stands with sufficient rated capacity before performing the following procedures.

NOTE: Machines with serial numbers before 1300 and some possibly after that number may be equipped with front motors that have integral hubs. **(see figure 2)** These units will not have a castle nut on the hub. If machine is equipped with an integral hub disregard this bulletin.

1. Use jack to lift front of machine (steering axle) and support with jack stands.
2. Remove both front wheels and remove hubs from front drive motors. **Figure 1**
3. Discard the original keys, cotter pins, and castle nuts.
4. Clean and inspect motor shafts for deformities or cracks around keyway. **Replace wheel motor shafts if they are cracked or deformed with UpRight part #031044-000 (Kit contains shafts and seals for two motors)**

Note: Wear on the keyway groove is normal and acceptable.

5. Replace shear keys 067607-018 and install hubs.
6. Install new castle nut 067607-021 and torque to 350 ft lbs. Install cotter pins 011754-012.
7. Reinstall wheels and torque lug bolts to 150 ft lbs.

** If you have any questions regarding this Service Bulletin, please contact the UpRight Product Support Department by telephone at (800) 926-5438 from within the USA or at (559) 662-3900 From Europe countries + 353 (0) 1 620 9300 (Ireland)



SERVICE BULLETIN SB03.01

Machines/Models: LX 31/41/50 4WD **Serial Numbers:** 1300-4472

FIGURE 1

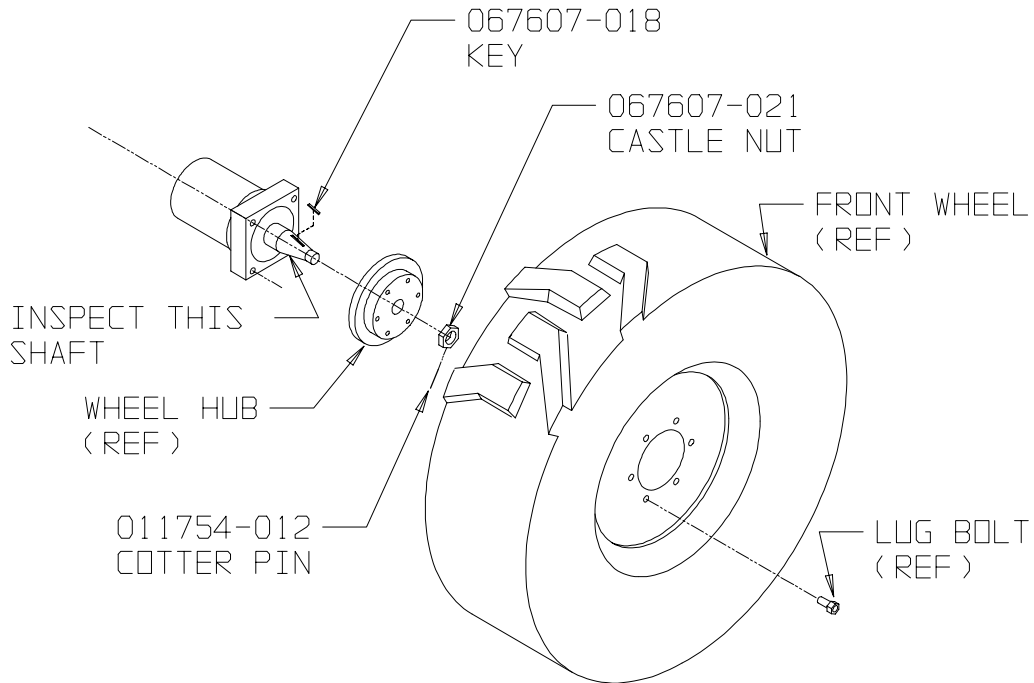
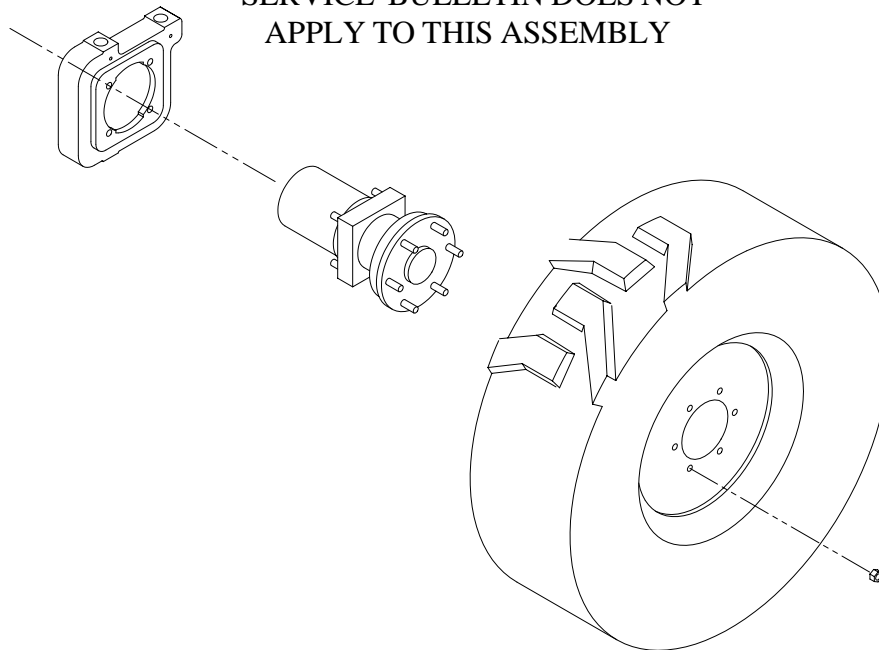

FIGURE 2

**SERVICE BULLETIN DOES NOT
APPLY TO THIS ASSEMBLY**



**** If you have any questions regarding this Service Bulletin, please contact the UpRight Product Support Department by telephone at (800) 926-5438 from within the USA or at (559) 662-3900 From Europe countries + 353 (0) 1 620 9300 (Ireland)**