

SERVICE BULLETIN

SB00.10

Serial Numbers: 1225-1365

Machines/Models: TL38 Manual Outriggers

THE PROCEDURE SPECIFIED IN THIS BULLETIN **MUST** BE PERFORMED AT THE NEXT 30 DAY MAINTENANCE INTERVAL.

DATE: July 1, 2000

PURPOSE: Enhance performance of the Main Hydraulic Manifold Cartridge Valves.

OPERATION REQUIRED: Replace the Cartridge Valves on the Main Hydraulic Manifold.

PARTS REQUIRED:

4 each - Cartridge Valve (058276-000)(S271Valve Identifier)

REIMBURSEMENT: UpRight will reimburse the owner of record for 1 hour of labor at \$60.00 per hour. Reimbursement will be made upon receipt by UpRight of your completed warranty claim form. Please reference SB00.10 on your warranty claim form.

PROCEDURE: Read all instructions thoroughly and refer to Figure 1 on the following page before starting.

1. Park the machine on a firm level surface.
2. Ensure the Elevating Assembly is completely stowed and the Key Switch, upper and lower Emergency Stop Switches are in the 'OFF' position.
3. Remove the Chassis Cover and gain access to the Main Hydraulic Manifold (see Figure 1).

NOTE: Identify the location of each Valve's Coils for correct reinstallation.

4. Remove the Knurled Securing Nut, the Valve Coil and Spacer O-Rings from each Cartridge Valve.
5. Remove the Cartridge Valve from the block.
6. Install the Supplied Cartridge Valve and torque to 25-30 Ft. Lbs. (34-41 Nm).
7. Install the Valve Coil, Spacer O-Rings and Knurled Securing Nut removed in step 4 and tighten finger tight.
8. Repeat the above operation for all Cartridge Valves to be changed.
9. Reinstall chassis cover and secure.
10. Perform the Pre-Operation and Safety Inspection as instructed in the Operator Manual to ensure proper operation of machine.

SERVICE BULLETIN

SB00.10

Serial Numbers: 1225-1365

Machines/Models: TL38 Manual Outriggers

TL38 MAIN MANIFOLD

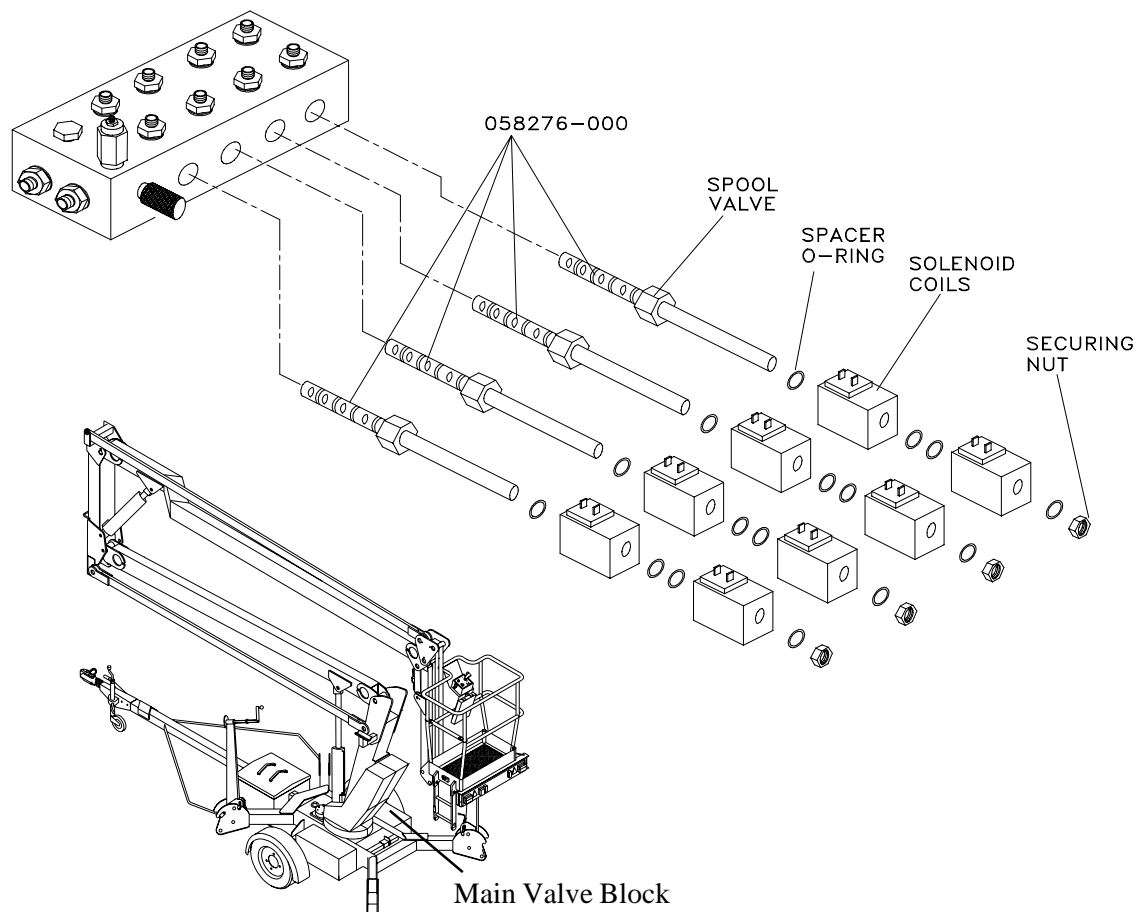

Figure 1

If you have any questions regarding this Service Bulletin, please contact the UpRight Product Support Department.

In North America

Tel: +1-559-891-5200

Fax: +1-559-896-9244

In Europe

Tel: +31 010 238 0000

Fax: +31 010 238 0001