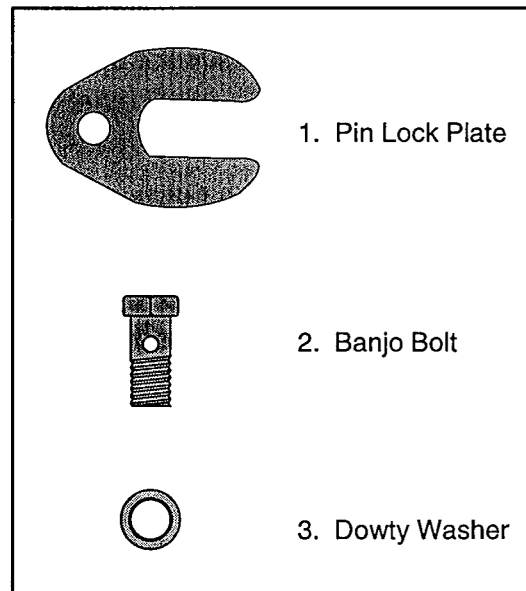

# SERVICE BULLETIN

## Outrigger Component Replacement

**SB97.2****Machines/Models: TL49****Serial Nos.: 1001-1056****THIS BULLETIN IS MANDATORY.****DATE:** February 1, 1997**PURPOSE:** To replace the present pin lock plates, banjo bolts, and dowty washers with current specifications.**OPERATION REQUIRED:** Replacement of pin lock plates, banjo bolts, and dowty washers.**PARTS REQUIRED: (Figure 1)**

1. 12 ea. 058056-000 Pin Lock Plates
2. 08 ea. 058188-000 Banjo Bolts
3. 16 ea. 057124-000 Dowty Washers

**REIMBURSEMENT:** Replacement of components will take less than one hour. UpRight will reimburse the owner of record for one hour of labor at \$30.00 per hour; and for travel (up to 100 miles) at \$0.25 per mile. Reimbursement will be made upon receipt by UpRight of your completed warranty claim form and the pin lock plates, banjo bolts, and dowty washers you replaced.**PROCEDURE:** Read all instructions thoroughly and refer to figures 1, 2, and 3 before starting.*Figure 1*

If you have any questions regarding this Service Bulletin, please contact the UpRight Product Support Department by telephone at (800) 926-5438 from within the USA or at (209) 891-5200 outside the USA or by FAX at (209) 896-9244.

# SERVICE BULLETIN

## Outrigger Component Replacement

**SB97.2**

**Machines/Models: TL49**

**Serial Nos.: 1001-1056**

### REPLACEMENT PROCEDURE

#### Pin Lock Plates

1. Ensure that the TL-49 is on a firm level surface and not raised, i.e. it is supported by its wheels and also that the outriggers are extended until they touch the ground but that they bear no load. The procedure written below are the steps to replace one set of lock plates and should be repeated for each of the other three outriggers.
2. Remove the securing bolts #5 and washers #6 from the three pin lock plates. (fig. 2)
3. Remove the three pin lock plates #4 (fig. 2).
4. Install supplied pin lock plates #4 (fig. 2).
5. Apply medium strength thread lock to lock plate securing bolt, install bolt #5 and washer #6 to each pin lock plate (fig. 2). Torque to 25 ft. lbs.

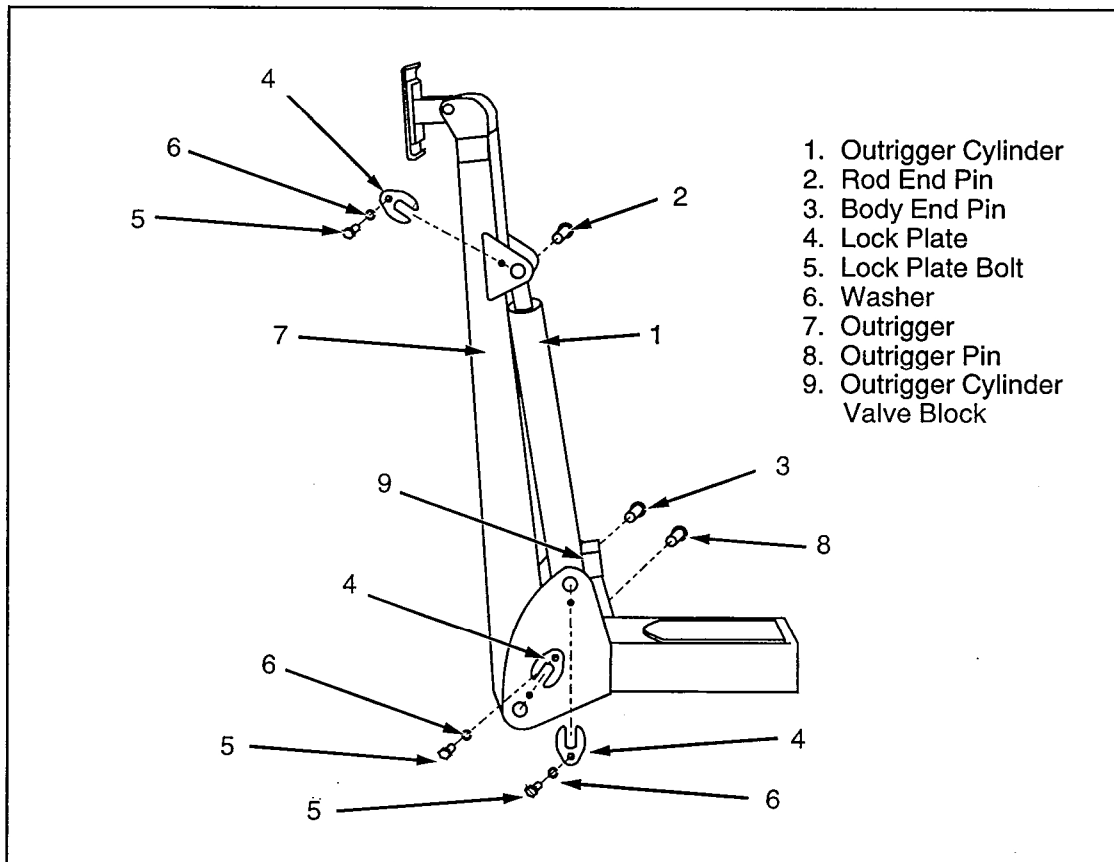

Figure 2

If you have any questions regarding this Service Bulletin, please contact the UpRight Product Support Department by telephone at (800) 926-5438 from within the USA or at (209) 891-5200 outside the USA or by FAX at (209) 896-9244.

# SERVICE BULLETIN

**Outrigger Component Replacement**

**SB97.2**

**Machines/Models: TL49**

**Serial Nos.: 1001-1056**

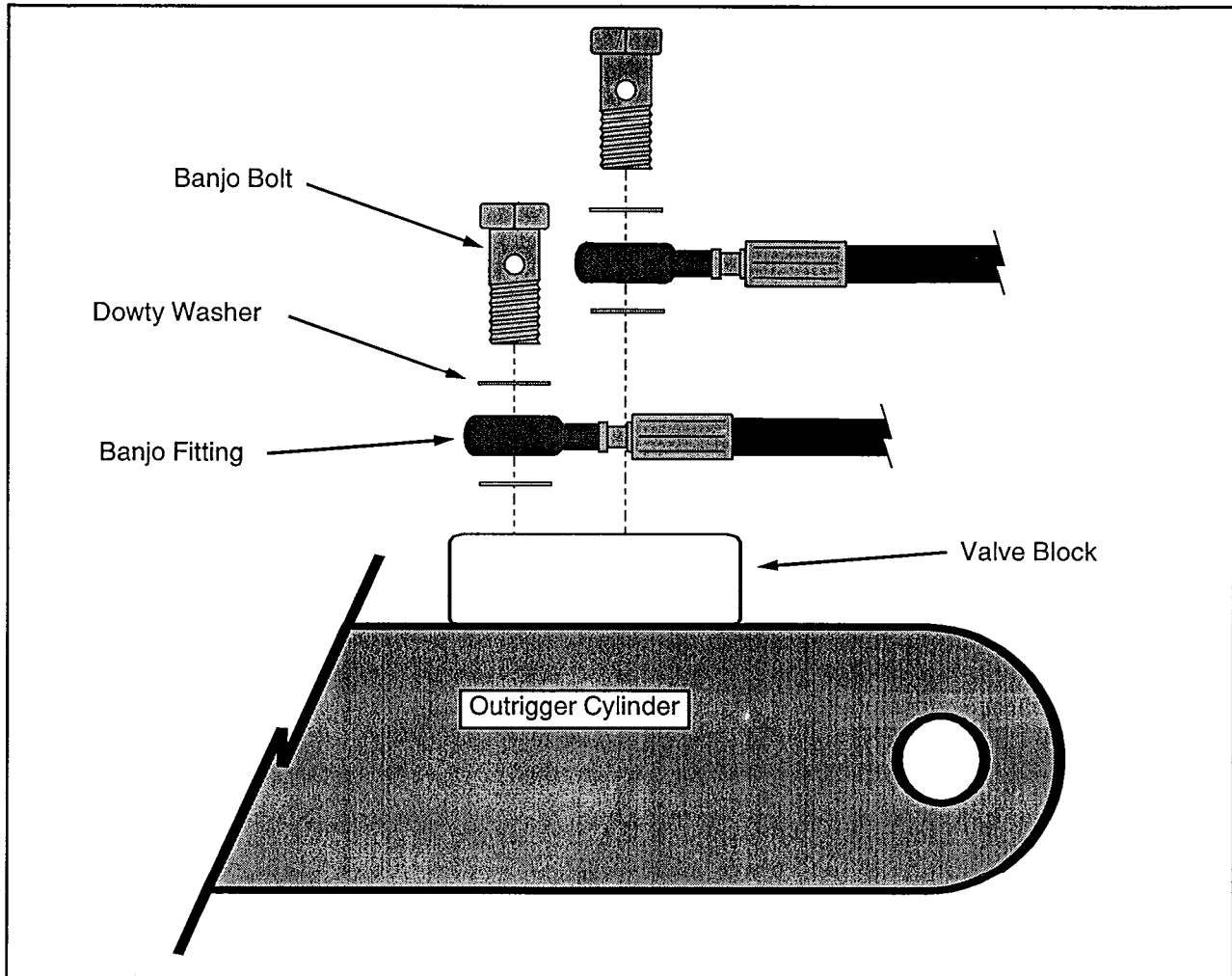

Figure 3

## Banjo Bolts and Dowty Washers

**Note:** Perform the following steps for each banjo fitting, repeat until all banjo bolts and dowty washers have been replaced. To avoid confusion, replace components to one banjo fitting at a time.

1. Remove existing banjo bolts and dowty washers, retain for return to factory.
2. Install replacement banjo bolts, dowty washers, and existing banjo fittings onto outrigger cylinder valve block per figure 3.
3. Torque banjo bolts to 25 ft. lbs.
4. Cycle each cylinder to bleed any air from system and test operation.

If you have any questions regarding this Service Bulletin, please contact the UpRight Product Support Department by telephone at (800) 926-5438 from within the USA or at (209) 891-5200 outside the USA or by FAX at (209) 896-9244.