



Service Information

SI02.02

MACHINE/MODELS: SL 26/30 RT/SL **SERIAL NUMBERS:** 11200-Current

DATE: July 31, 2002

PURPOSE: Improve Performance and Reliability of Hyd Drive Motors.

Procedure: Optional

Warranty Reimbursement: None

Parts Needed: SI 02.02 Hose Reroute Kit

Important! If this hose kit is installed following a wheel motor failure, the complete drive system **MUST** be disassembled and cleaned of debris before replacement motors are installed. Failure to do so will result in continued wheel motor failure.

Instructions

Read all instructions before beginning. Refer to figures 1, 2 and 3 for location and identification of the components to be installed.

While performing this procedure always follow all applicable safety rules which includes wearing safety goggles. Other practices, more specific to this procedure are;

- Allow hydraulic oil to cool before you begin, to avoid burns.
- Cap or plug any hose or fitting once separated to prevent oil leakage and contamination from dirt. Leave caps and plugs on new hoses until ready to install.
- Always use a drain pan to catch spilled oil and dispose of waste oil according to applicable laws.
- Many of the plastic ties will be cut and removed during this procedure, take note of hose routing and tie placement before removal to ensure proper placement once the procedure is complete. Rout new hoses consistent with the existing hoses.

1. Thoroughly clean the chassis and park machine on a hard level surface free from dirt and blowing dust.
2. Remove the negative battery cable.
3. Using an approved lifting device, lift the front and rear of the chassis, support at each corner with suitable blocking or stand.
4. Remove and discard both hoses from the relief valve at the left rear motor top port.
5. Remove the relief valve block from the same motor and retain for installation later.
6. Find the 78" (198cm) hose, (part number 064156-043 provided in the kit) and attach one end to the left rear motor fitting left open in step 5. Rout the other end of the hose toward the left front wheel but leave unattached for now.

If you have any questions regarding this Service Information Letter, please contact the UpRight Product Support Department by telephone at (800) 926-5438 from within the USA or at (559)662-3900 from Europe countries +353 (0) 1 620 9300 (Ireland)



Service Information

SI02.02

MACHINE/MODELS: SL 26/30 RT/SL

SERIAL NUMBERS: 11200-Current

7. Remove and discard the bottom hose from the right rear wheel motor (if not already done in step 4.). Find the 133" (338cm) hose (part number 064156-133 provided in the kit) and attach one end to the same fitting on the motor. Rout the other end of the hose through the chassis toward the left side of the machine (following the other hoses) then back toward the right front of the **engine** module. Do not attach at this time.
8. Remove the hose from the bottom bulkhead fitting, located inside the lower/front of the engine module on the right side of the machine (see figure 3).
9. Install the relief valve block (removed in step 5) to the same bulkhead fitting left open in the previous step, using the existing fittings. Install it so that the two fittings are toward the rear of the machine and relief valve toward the center of the machine.
10. Find the hose, left available in step 7 and attach it to the large fitting on the newly installed relief valve block.
11. Find the 75" (190cm) hose (part number 068737-075 provided in the kit) and attach one end to the small fitting on the newly installed relief valve block.
12. Rout the other end of the 75" hose to the valve block, following common hose paths, and attach it to the fitting left open in step 4 (Rear-center of main valve block, see figure 2 item 27 for location).
13. Assemble the new relief valve block with all parts supplied in the kit. See figure 1. Assemble item 14, (relief valve) into the largest port of item 15, (valve block). Then install item 13, (o-ring) on to the short side (without the nut) of item 12 (fitting-bulkhead). Install the o-ringed side of item 12 into the valve block (item 15). Install item 17 (fitting adapter) into valve block. Install item 16 (fitting adapter) into valve block. The relief valve block should now be fully assembled.
14. Remove and discard the large hose from the existing relief valve block, located behind the front/lower of the left side (control) module (the other end of this hose was left open in step 8). Install the hose that was left available in step 6, to the fitting.
15. Refer to the hose below the Relief valve mentioned in step 14. Remove both hoses from the lower bulkhead fitting leaving the opposite ends of both hoses attached. Remove and discard the bulkhead fitting.
16. Install the newly assembled relief valve block in the same location with the bulkhead fitting in the hole. Install retaining nut on the bulkhead fitting and install the hoses to the relief valve block.

If you have any questions regarding this Service Information Letter, please contact the UpRight Product Support Department by telephone at (800) 926-5438 from within the USA or at (559)662-3900 from Europe countries +353 (0) 1 620 9300 (Ireland)



Service Information

SI02.02

MACHINE/MODELS: SL 26/30 RT/SL

SERIAL NUMBERS: 11200-Current

17. Find the 41" (104cm) hose (part number 107090-041 provided in the kit) and install the straight end to the small fitting on the newly install relief valve block. Route other end toward the valve block (left side) but do not attach at this time.
18. Remove the small hose from the relief valve block (above the newly installed relief valve block mentioned in step 17). Remove the other end of this hose either from the main valve block or from the hydraulic tank.
19. Find the tee fitting (item 2 of figure 1, part number 015961-004) in the kit. Install it in the same position as the hose in step 18 was removed from, either on the main valve block or the hydraulic tank.
20. Find the 40" (102cm) hose (part number 068737-040 provided in the kit) and install one end to the relief valve block, to replace the hose removed in step 18. Rout the hose to the newly installed tee fitting and attach it.
21. Find the other end of the hose installed in step 17 and attach it to the same tee fitting as mentioned in step 20.
22. Refer to the backside of the main valve block. Swap the hoses at the positions 1 and 2 (the valve block is not numbered, refer to figure 2 to identify the correct hoses)
23. Remove the flow divider valve from the front face of the main valve block (refer to figure 3 for location). Find the plug (item 1 provided in the kit) and install it in place of the flow divider valve.
24. Replace any plastic tie that was cut and secure hoses from potential damage.
25. Using an approved lifting device, lift the front and rear of the machine and remove the stands or blocking. Lower machine onto its wheels. Check Hyd Fluid Level and add oil if necessary.
26. Drive the machine to ensure proper operation. Check hose routing for possible chafing or crushing damage. Inspect for leaks.
27. The machine will show a slight increase in drive speed, therefore some adjustment to the elevated drive speed will be necessary. Measure a 20 foot (6.1meter) course on flat level ground. With the platform elevated to 10 feet (3 meter) drive the full length of the course and measure the time. The elevated drive speed should be set so that it takes 27-28 seconds to drive the 20 foot (6.1 meter) course. See the maintenance section of the Parts and Service Manual under "Proportional Controller Adjustment" for complete information.

Perform a full function test of the machine according to UpRight specifications (see operators manual). Add hydraulic oil as necessary.

If you have any questions regarding this Service Information Letter, please contact the UpRight Product Support Department by telephone at (800) 926-5438 from within the USA or at (559)662-3900 from Europe countries +353 (0) 1 620 9300 (Ireland)



Service Information

SI02.02

MACHINE/MODELS: SL 26/30 RT/SL **SERIAL NUMBERS:** 11200-Current

FIGURE 1

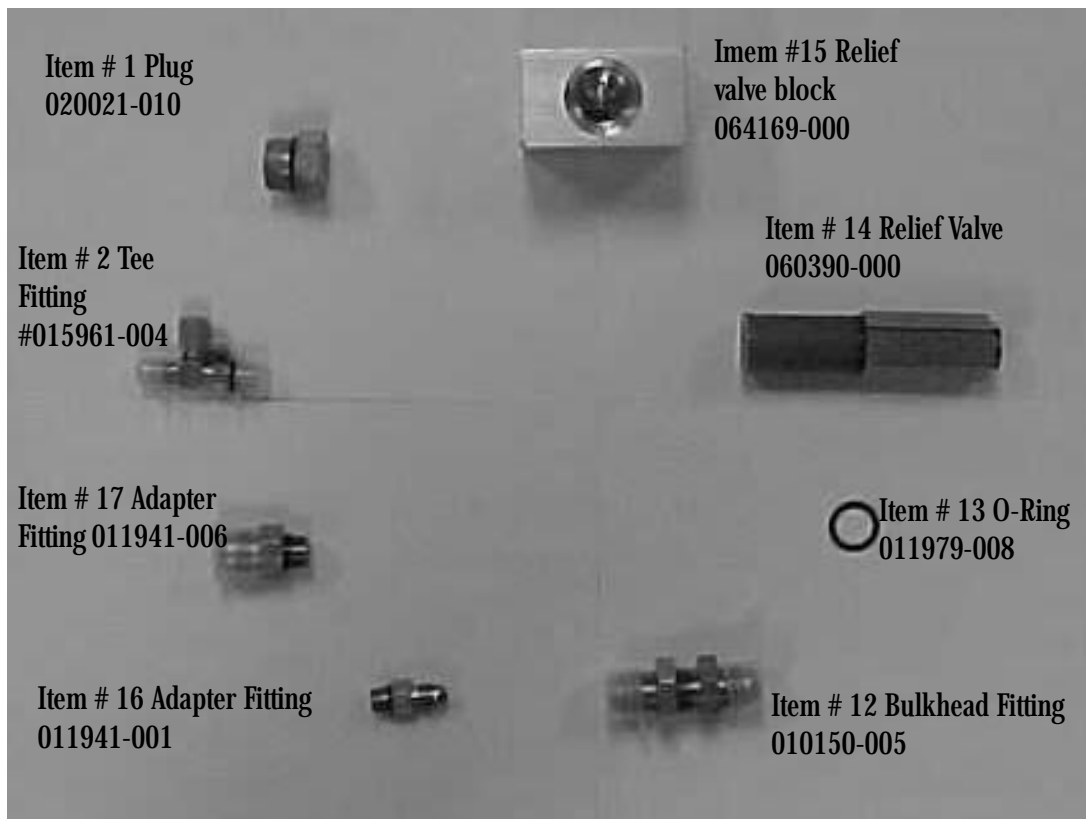

If you have any questions regarding this Service Information Letter, please contact the UpRight Product Support Department by telephone at (800) 926-5438 from within the USA or at (559)662-3900 from Europe countries +353 (0) 1 620 9300 (Ireland)



Service Information

SI02.02

MACHINE/MODELS: SL 26/30 RT/SL

SERIAL NUMBERS: 11200-Current

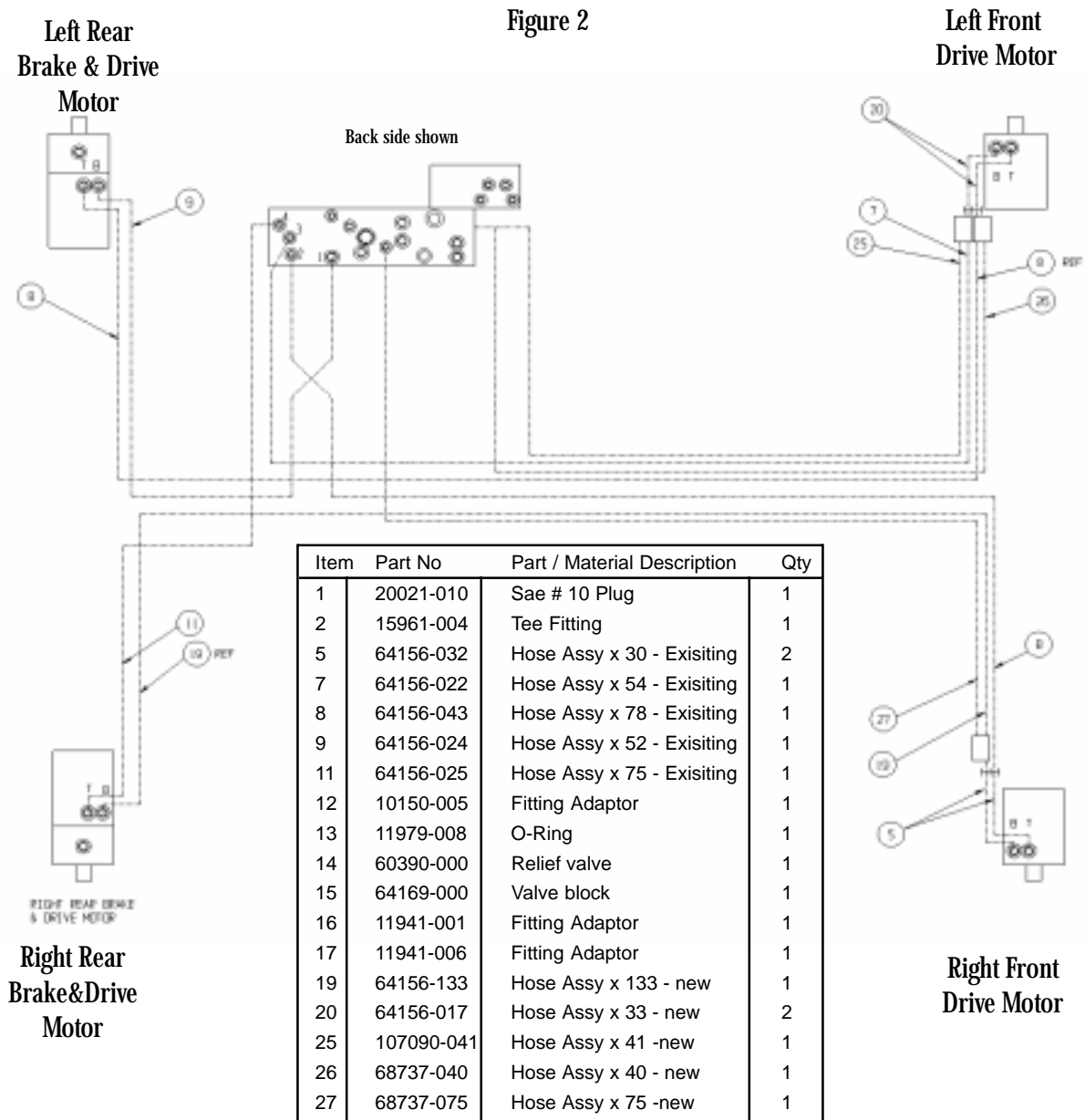

If you have any questions regarding this Service Information Letter, please contact the UpRight Product Support Department by telephone at (800) 926-5438 from within the USA or at (559)662-3900 from Europe countries +353 (0) 1 620 9300 (Ireland)



Service Information

SI02.02

MACHINE/MODELS: SL 26/30 RT/SL

SERIAL NUMBERS: 11200-Current

Figure 3

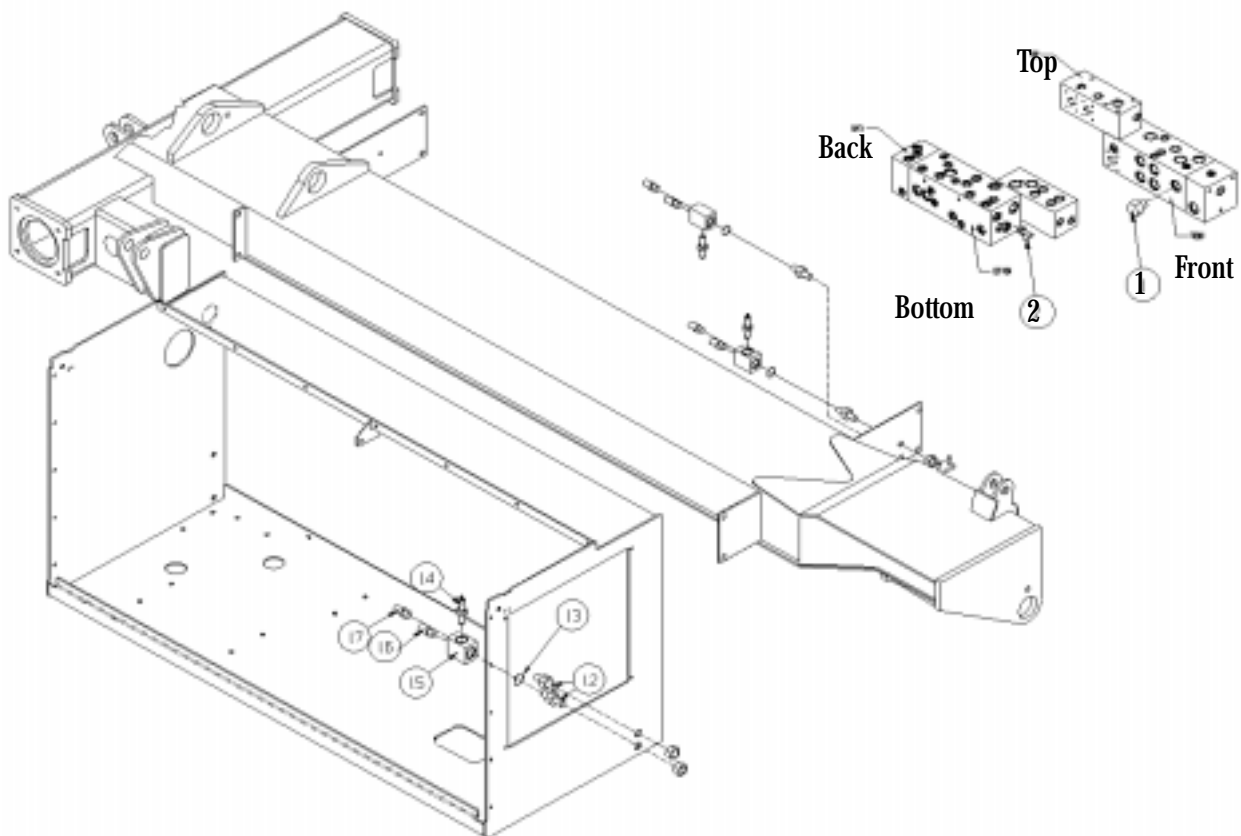

If you have any questions regarding this Service Information Letter, please contact the UpRight Product Support Department by telephone at (800) 926-5438 from within the USA or at (559)662-3900 from Europe countries +353 (0) 1 620 9300 (Ireland)